

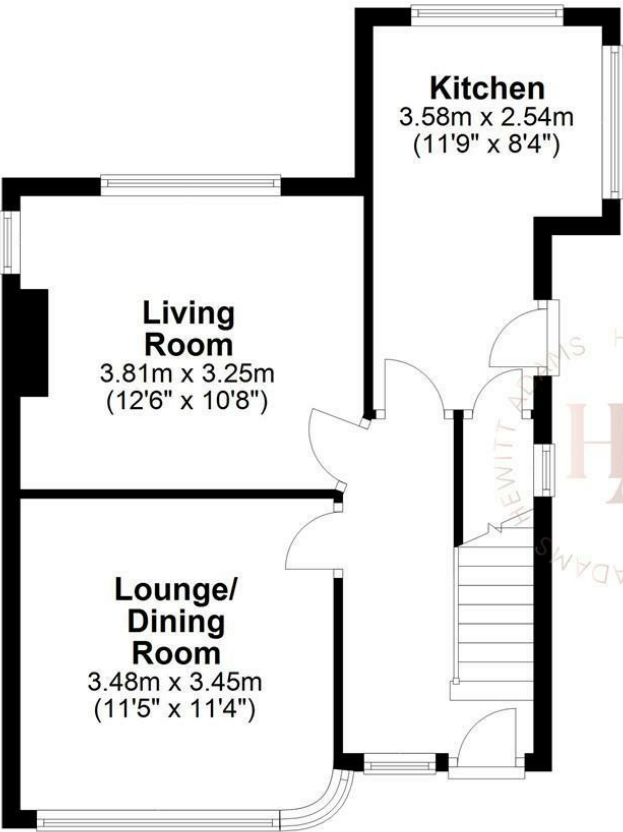

Ground Floor

Approx. 42.5 sq. metres (457.1 sq. feet)



First Floor

Approx. 37.4 sq. metres (402.4 sq. feet)

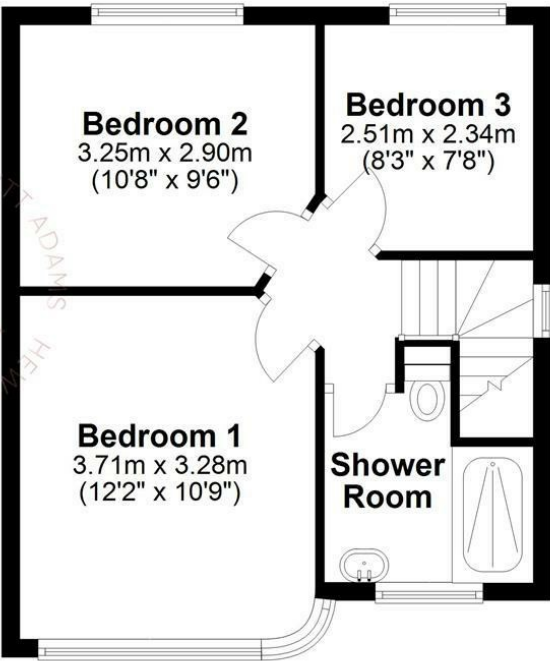

Total area: approx. 79.8 sq. metres (859.5 sq. feet)
For illustration purposes only - not to scale

Barnsdale Avenue, Wirral, CH61 1BG

Offers Over £300,000

3 Bedroom 2 Reception 1 Bathroom D

****Stunning Three Bedroom Semi - Immaculate Condition - Perfect First Time Buy - Must View****

Hewitt Adams is excited to market this absolute gem on the SOUGHT AFTER Barnsdale Avenue in Thingwall. This stunning home has been UPGRADED and RENOVATED to a gorgeous standard by the current owners and comes the market in SHOW-HOME condition.

With wonderful features like WOOD-PANELLING, BESPOKE STAIRCASE WINE-RACK, LOG-BURNING STOVE, NEW SHOWER-ROOM, RE-WIRE, re-plastering and decoration and much more!

In brief the accommodation affords: entrance hall, lounge, living room, extended kitchen. Upstairs there are three bedrooms and a modern shower-room.

With a large driveway, detached garage and a LANDSCAPED rear garden with patio areas, a lawned garden, garden shed.

Absolutely perfectly suited to FIRST TIME BUYERS or FAMILIES - Call Hewitt Adams on 0151 342 8200 to view.

Front Entrance

New front door into:

Hall

Staircase with glazed balustrade, with a bespoke wine-rack and storage area, radiator

Lounge / Dining Room

10'9" x 11'1" (3.3 x 3.4)

Double glazed window, radiator, power points, wood-panelled walls

Living Room

11'1" x 11'9" (3.4 x 3.6)

Log-burning stove, radiator, power points, double glazed doors to garden

Kitchen

8'6" x 17'8" (2.6 x 5.4)

Stylish modern kitchen with wall and base units, inset sink, integrated appliances, side door to garden, double glazed window

UPSTAIRS

Bedroom One

12'1" x 9'4" (3.7 x 2.87)

Double glazed window with fitted blinds, wood-panelled walls, radiator, power points

Bedroom Two

9'6" x 10'2" (2.9 x 3.1)

Double glazed window, radiator, power points

Bedroom Three

7'7" x 7'9" (2.33 x 2.37)

Double glazed window, radiator, power points

Shower-Room

Stylish modern shower-room with shower, low level W.C, hand wash basin, heated towel rail, tiled floor, double glazed window

EXTERNALLY

With a large driveway, detached garage and a

LANDSCAPED rear garden with patio areas, a lawned garden, garden shed.

